

INVERTED SERIES

Cargo Roller Casters

Revvo supplies a range of inverted roller casters for air cargo handling in the aviation industry. These casters can withstand the severest strain as evidenced by rigorous testing that showed no signs of caster failure after passing a standard roller over a ramp 25,000 times.

Inverted Series swivel casters are available in three models with wheel diameters of 2-1/4" and 2-3/4" and load capacities of 450 lbs. KSL models are fitted with a rectangular top plate and feature protective toe guards. LSL/HSL models can be fitted with either an oblong top plate standard, or the KSL rectangular top plate as an alternative.



KSL



LSL/HSL

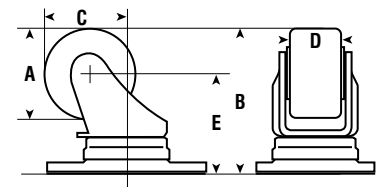
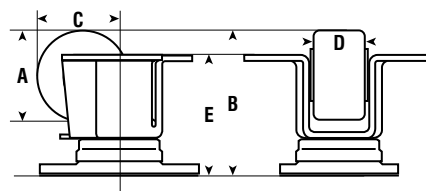

A = Wheel Diameter B = Overall Height C = Swivel Radius D = Tread Width

INVERTED SERIES

A	B	C	D	E	Load Capacity	Bearing	Wheel	Swivel Part #
2-1/4"	3-3/4"	2-1/2"	1-3/8"	3"	450	Precision Ball	Nylon	KSL 058 NY2L T25
2-1/4"	3-3/4"	2-1/2"	1-3/8"	2-1/2"	450	Precision Ball	Nylon	LSL 058 NY2L
2-1/4"	3-3/4"	2-1/2"	1-3/8"	2-1/2"	450	Precision Ball	Nylon	LSL 058 NY2L T25
2-3/4"	4"	2-1/2"	1-3/8"	2-3/4"	450	Precision Ball	Nylon	HSL 070 NY2L
2-3/4"	4"	2-1/2"	1-3/8"	2-3/4"	450	Precision Ball	Nylon	HSL 070 NY2L T25

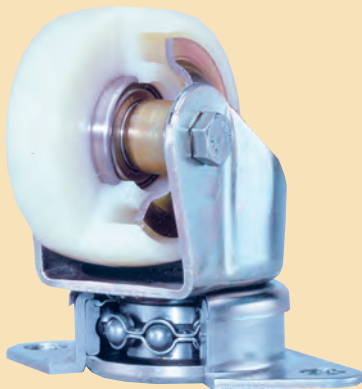

Inverted casters are tested to provide a long service life

Standard Top Plate (KSL)

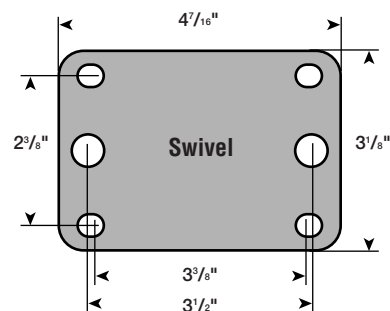

KSL top plates have corner fixing holes to suit 5/16" diameter bolts (other holes up to 1/2"). Also used as alternative T25 top plate for LSH/HSL series.

Standard Top Plate (LSL/HSL)

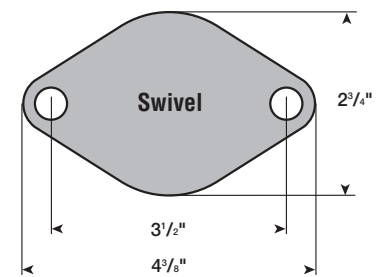

LSL/HSL top plates have corner fixing holes to suit 3/8" diameter bolts.

Alternative T25 Top Plate (LSL/HSL)

- Same top plate design and specifications as used in KSL Series (see above left).
- To order, select Swivel Part # with suffix T25.